

BLOCK 1 - SECOND FLOOR PODIUM PLAN
SCALE:1:100

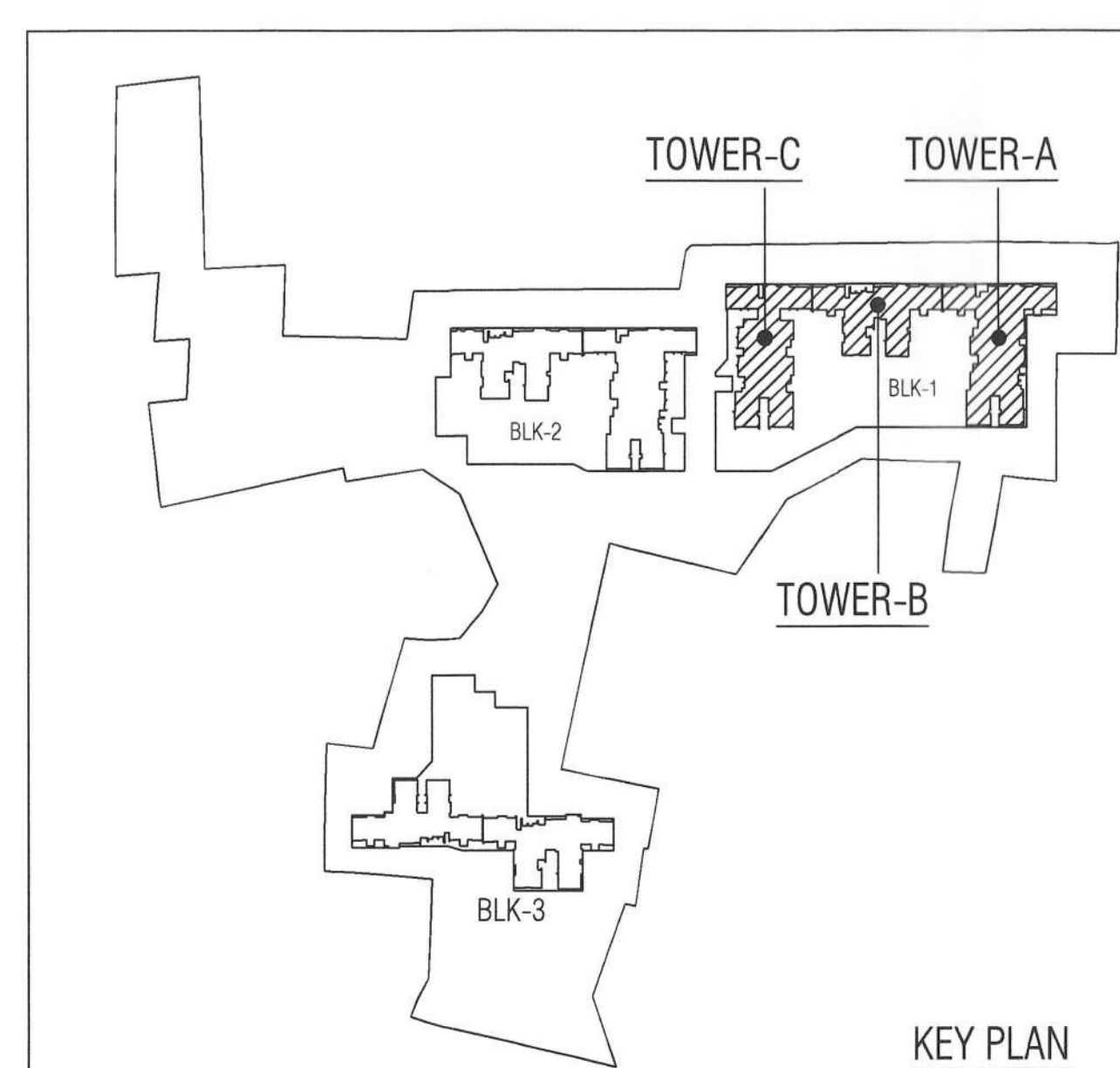

SCHEDULE OF DOORS & WINDOWS									
DOORS:					WINDOWS:				
MKD	WIDTH	HEIGHT	SILL	LINTEL	MKD	WIDTH	HEIGHT	SILL	LINTEL
SW1	1500	2100	150	2200	W1	1500	1000	400	2200
SW2	1800	2300	150	2200	W2	1200	1800	400	2200
DP	900	2200	00	2200	W3	1200	1800	400	2200
DP	900	2200	00	2200	W4	900	1400	400	2200
D1	1100	2200	00	2200	W4	600	1800	400	2200
D3	750	2200	00	2200	W4	600	900	1300	2200
D3	2400	2200	00	2200	W4	450	1400	400	2200
D3	2700	2200	00	2200	SW	SW	STAIRCASE WINDOW		As per elevation
SD1	1800	2200	00	2200	GL2	GL2	GLAZING		As per elevation
STAF	1800	2200	00	2200	GL21	900	1800	400	2200
STOF	1350	2200	00	2200	Vw	Vw	Ventilation Window		Above lintel
STUBA	1200	2200	00	2200					
TRD3	1200	2200	00	2200					
TRD7	750	2200	00	2200					
TRW	750	2200	00	2200					

- NOTE:
1. ALL DIMENSIONS ARE IN MM. UNLESS OTHERWISE MENTIONED.
 2. ALL EXTERNAL WALLS ARE 160 THK & INTERNAL WALLS ARE 125 THK. IF NOT STATED IN 1:4 CEMENT SAND MORTAR.
 3. ALL ELEVATION PROJECTIONS ARE 500 MM. PROJECTED.
 4. DEPTH OF UNDERGROUND WATER RESERVOIR SHOULD NOT EXCEED THE DEPTH OF FOUNDATION.
 5. ANY DISCREPANCY IN SCALE, THE WRITTEN DIMENSION SHALL GOVERN.
 6. FOR SPECIFICATION OF MATERIALS & WORKMANSHIP N.B.C. 2016 TO BE FOLLOWED.
 7. OPEN TERRACE WITH LIME TERRAZZOING OF RATIO 2:2:7.
 8. FLY ASH AND FLY ASH BASED MATERIAL WILL BE USED IN THE PROJECT.
 9. SOLAR ENERGY OF 2% OF THE CONNECTED LOAD WILL BE USED IN THIS PROJECT.
 10. FOR NO. 12SR/21/166/86300004/45
 11. AN MEMO NO. KOLK/EST/16/08/022/688906

CERTIFICATE OF THE OWNER
I HAVE GONE THROUGH THE BUILDING RULES OF WEST BENGAL MUNICIPAL (BUILDING RULES), 2007 AND ITS AMENDMENT & ALSO UNDERTAKE TO ABIDE BY THOSE RULES DURING & AFTER THE CONSTRUCTION OF THE BUILDING.

SRIJAN RESIDENCY LLP
36/1A ELGIN ROAD
KOLKATA - 700020
SIGNATURE OF OWNER

CERTIFIED THAT THE STRUCTURAL DRAWINGS AND DESIGN OF BOTH THE FOUNDATION AND SUPERSTRUCTURE OF THE BUILDING BUILDINGS HAS BEEN MADE CONSIDERING THE SOIL TEST REPORT AS PER THESE RULES AND REGULATIONS MADE UNDER THE ACT AND ALSO CONSIDERING ALL POSSIBLE LOADS, SEISMIC LOADS AND THE MOMENTS GENERATED BY THE PROPOSED STRUCTURE AS PER THE BUREAU OF INDIAN STANDARD AND NATIONAL BUILDING CODE OF INDIA AND CERTIFIED THAT IT IS SAFE AND STABLE IN ALL RESPECTS AND THESE PROVISIONS SHALL BE ADHERED TO DURING THE CONSTRUCTION.

UTPAL SANTRA
R.C.E., M.C.E. (STRUCTURE)
FILE: P/20021
SIGNATURE OF STRUCTURAL REVIEWER

ANKIT AGRAWALA
ENROLLMENT NO. STR/NKDA/10/00105
SIGNATURE OF STRUCTURAL ENGINEER

IT IS CERTIFIED THAT THE COMPREHENSIVE GEO-TECHNICAL REPORT ON SOIL INVESTIGATION HAS BEEN PREPARED BY ME FOR DESIGN AND CALCULATION OF THE FOUNDATION BY ANALYZING THE SOIL SAMPLE FOR ESTIMATING THE BEARING CAPACITY OF THE SOIL ON WHICH FOUNDATION OF THE STRUCTURE WILL BE CONSTRUCTED.

I SHALL ALSO CHECK THE NATURE OF THE SOIL AFTER EXCAVATION AT SITE SO THAT FOUNDATION IS EXTENDED UP TO APPROPRIATE DEPTH THAT HAS BEEN PROPOSED IN THE GEO-TECHNICAL REPORT.

JISHU PAL
ENROLLMENT NO. GTR/NKDA/10/00043
SIGNATURE OF GEOTECHNICAL ENGINEER

KAMAL KUMAR PERIHAL
SIGNATURE OF ARCHITECT
ENROLLMENT NO. ACH/NKDA/10/00016
C.O.A REGISTRATION NO. CA-95-18679

ARPAN DAS GUPTA
ARCHITECT
ENROLLMENT NO. TOWN PLANNER
EMP. NO. - T/11/R/NKDA/20/00003
SIGNATURE OF TOWN PLANNER

ARPAN DASGUPTA
ENROLLMENT NO. TPER/NKDA/20/00003

PROJECT :
PROPOSED G+18(TOWER A, G,J) G+19(TOWER B,H,I,K) STORED RESIDENTIAL BUILDING MAUZA-KALABERIA, JL NO.30, LR DAG NO : 11(P), 12(P), 13, 15, 16, 17, 18, 19, 20, 21, 22, 23, 24, 25, 26, 27(P), 28(P), 42, 43(P), 44(P), 74, 79, 80 & MAUZA BHATENDA, PS - Rajarhat, NORTH-24 PGS. PIN - 700135

CONTENTS :
BLOCK 1 (A,B,C) - SECOND FLOOR PODIUM PLAN

SUBMISSION DRAWING	SHEET NO. - 04/37
NORTH	MA/RAJARHAT/SUB/ARCH/04

REV. DATE	-	REV. NO.	-
SCALE	1:100	DEALT	
DATE	09.03.2024	CHECKED	M.B.

ARCHITECT :
MAHESHWARI & ASSOCIATES
37A, BAKER ROAD, 2ND FLOOR, ALIPORE,
KOLKATA-27
TEL. : 65228584, www.architectm.com

KEY PLAN (N.T.S)

SANCTIONED & APPROVED

Executive Officer
Rajahat Panchayat Samit
Rajahat, North 24 Pargana

NO. OF SHEETS: 01
DATE: 01.10.2024

Note: This NOC has been issued on the basis of documents submitted by the applicant and reviewed by the Asst. Executive Officer, North 24 Pargana Zilla Panchayat. It does not constitute any representation of fact or truthfulness of the project or any other matter connected with the above project including the proposed layout, plans, drawings, design etc. Also, this NOC shall remain valid.

STRUCTURAL DRAWINGS, STRUCTURAL DESIGN CALCULATIONS & SOIL TEST REPORT ARE NOT CHECKED AND KEPT FOR RECORDS ONLY.

NEW TOWN KOLKATA DEVELOPMENT AUTHORITY
Sanction of Building Plan for Construction Purpose
Memo No. 4623/NKDA/EP/2024
Date: 01.10.2024

NOTE: ALL RECOMMENDATIONS FROM POLLUTION CONTROL BOARD SHOULD BE THOROUGHLY FOLLOWED AT THE TIME OF CONSTRUCTION

Approval Order No. 16411RPS
Date: 25.11.2024
Valid up to: 29.11.2029

Building Particulars: No Objection Certificate for issuance of completion certificate of proposed G+8 (TOWER A, B, C, D, E, F, G, H, I, J, K, L, M, N, O, P, Q, R, S, T, U, V, W, X, Y, Z, AA, AB, AC, AD, AE, AF, AG, AH, AI, AJ, AK, AL, AM, AN, AO, AP, AQ, AR, AS, AT, AU, AV, AW, AX, AY, AZ, BA, BB, BC, BD, BE, BF, BG, BH, BI, BJ, BK, BL, BM, BN, BO, BP, BQ, BR, BS, BT, BU, BV, BW, BX, BY, BZ, CA, CB, CC, CD, CE, CF, CG, CH, CI, CJ, CK, CL, CM, CN, CO, CP, CQ, CR, CS, CT, CU, CV, CW, CX, CY, CZ, DA, DB, DC, DD, DE, DF, DG, DH, DI, DJ, DK, DL, DM, DN, DO, DP, DQ, DR, DS, DT, DU, DV, DW, DX, DY, DZ, EA, EB, EC, ED, EE, EF, EG, EH, EI, EJ, EK, EL, EM, EN, EO, EP, EQ, ER, ES, ET, EU, EV, EW, EX, EY, EZ, FA, FB, FC, FD, FE, FF, FG, FH, FI, FJ, FK, FL, FM, FN, FO, FP, FQ, FR, FS, FT, FU, FV, FW, FX, FY, FZ, GA, GB, GC, GD, GE, GF, GG, GH, GI, GJ, GK, GL, GM, GN, GO, GP, GQ, GR, GS, GT, GU, GV, GW, GX, GY, GZ, HA, HB, HC, HD, HE, HF, HG, HH, HI, HJ, HK, HL, HM, HN, HO, HP, HQ, HR, HS, HT, HU, HV, HW, HX, HY, HZ, IA, IB, IC, ID, IE, IF, IG, IH, II, IJ, IK, IL, IM, IN, IO, IP, IQ, IR, IS, IT, IU, IV, IW, IX, IY, IZ, JA, JB, JC, JD, JE, JF, JG, JH, JI, JJ, JK, JL, JM, JN, JO, JP, JQ, JR, JS, JT, JU, JV, JW, JX, JY, JZ, KA, KB, KC, KD, KE, KF, KG, KH, KI, KJ, KK, KL, KM, KN, KO, KP, KQ, KR, KS, KT, KU, KV, KW, KX, KY, KZ, LA, LB, LC, LD, LE, LF, LG, LH, LI, LJ, LK, LL, LM, LN, LO, LP, LQ, LR, LS, LT, LU, LV, LW, LX, LY, LZ, MA, MB, MC, MD, ME, MF, MG, MH, MI, MJ, MK, ML, MM, MN, MO, MP, MQ, MR, MS, MT, MU, MV, MW, MX, MY, MZ, NA, NB, NC, ND, NE, NF, NG, NH, NI, NJ, NK, NL, NM, NN, NO, NP, NQ, NR, NS, NT, NU, NV, NW, NX, NY, NZ, OA, OB, OC, OD, OE, OF, OG, OH, OI, OJ, OK, OL, OM, ON, OO, OP, OQ, OR, OS, OT, OU, OV, OW, OX, OY, OZ, PA, PB, PC, PD, PE, PF, PG, PH, PI, PJ, PK, PL, PM, PN, PO, PP, PQ, PR, PS, PT, PU, PV, PW, PX, PY, PZ, QA, QB, QC, QD, QE, QF, QG, QH, QI, QJ, QK, QL, QM, QN, QO, QP, QQ, QR, QS, QT, QU, QV, QW, QX, QY, QZ, RA, RB, RC, RD, RE, RF, RG, RH, RI, RJ, RK, RL, RM, RN, RO, RP, RQ, RR, RS, RT, RU, RV, RW, RX, RY, RZ, SA, SB, SC, SD, SE, SF, SG, SH, SI, SJ, SK, SL, SM, SN, SO, SP, SQ, SR, SS, ST, SU, SV, SW, SX, SY, SZ, TA, TB, TC, TD, TE, TF, TG, TH, TI, TJ, TK, TL, TM, TN, TO, TP, TQ, TR, TS, TT, TU, TV, TW, TX, TY, TZ, UA, UB, UC, UD, UE, UF, UG, UH, UI, UJ, UK, UL, UM, UN, UO, UP, UQ, UR, US, UT, UY, UZ, VA, VB, VC, VD, VE, VF, VG, VH, VI, VJ, VK, VL, VM, VN, VO, VP, VQ, VR, VS, VT, VU, VV, VW, VX, VY, VZ, WA, WB, WC, WD, WE, WF, WG, WH, WI, WJ, WK, WL, WM, WN, WO, WP, WQ, WR, WS, WT, WU, WV, WW, WX, WY, WZ, XA, XB, XC, XD, XE, XF, XG, XH, XI, XJ, XK, XL, XM, XN, XO, XP, XQ, XR, XS, XT, XU, XV, XW, XX, XY, XZ, YA, YB, YC, YD, YE, YF, YG, YH, YI, YJ, YK, YL, YM, YN, YO, YP, YQ, YR, YS, YT, YU, YV, YW, YX, YY, YZ, ZA, ZB, ZC, ZD, ZE, ZF, ZG, ZH, ZI, ZJ, ZK, ZL, ZM, ZN, ZO, ZP, ZQ, ZR, ZS, ZT, ZU, ZV, ZW, ZX, ZY, ZZ

Assistant Architect
Executive Architect
Chief Architect

BLOCK - THIRD FLOOR PLAN

CONTENTS
BLOCK 1 (A, B, C) - THIRD FLOOR PLAN